

Electromagnetic Lock Installation Instruction (Waterproof Series)

Optional Bracket

Identify the door swinging direction and inspect the door frame header to determine if bracket is required. A L- bracket, LZ-bracket or U-bracket (optional) may be required for the electromagnet depending on the frame header and swinging direction.

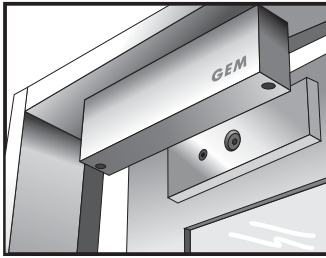

Regular Installation

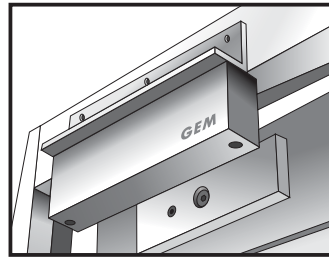

With L-bracket for narrow door frames

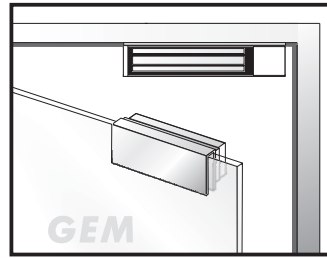

With U-bracket for frameless glass door leaf

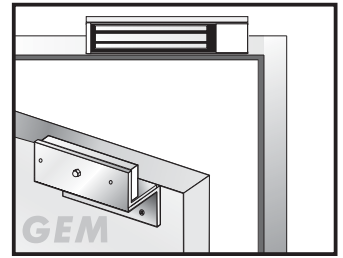

With LZ-bracket for in-swinging door frames

Regular Installation

① Fold the mounting template along the dotted line to a 90-degree angle.

Template

② Close the door, place the template against the door and frame. Drill two holes in the frame and three holes in door as indicated on the template.

③ Drill two holes in the frame and three holes in the door as indicated on the template.

Frame
Door

④ Mounting the armature plate to the door. Actual installation varies according to door style.

Armature Plate

Rubber Washer

This will allow the armature plate to pivot slightly around the armature screw in order to compensate for door misalignment.

⑤

<p>Hollow Metal Door</p> <p>12.7mm 8mm</p> <p>Drill an 8 mm hole through door, from sexnut bolt side only, enlarge the 8mm hole to 12.7mm.</p>	<p>Reinforced Door</p> <p>6.8mm for M8-1.25 thread</p> <p>Drill an 6.8 mm dia. Hole and tap for M8x12.5 thread.</p>	<p>Solid Door</p> <p>12.7mm 8mm 36mm</p> <p>Drill an 8 mm hole thru door from sexnut bolt side of door, drill 12.7mm hole, 36mm in depth.</p>
---	--	--

⑥ Screw the two self-tapping screws in the slotted holes of the mounting plate and adjust the position of the mounting plate.

⑦ 9.4mm holes for M6 Blind Nuts.
7mm holes for M5 Blind Nuts.

⑧ Use the screws to permanently mount the mounting plate, mount the magnet with hardware provided.

Fixing screw

⑨ Connect the power lead, and test the unit. Close the door, use the Allen wrench or add washers to adjust the gap of Armature plate and the magnet.

⑩ Connect the power lead, and test the unit. Insert the anti-tamper caps into the mounting screw access holes.

Power

Holding Force

Installation Steps of LZ or Z bracket for In-swinging doors

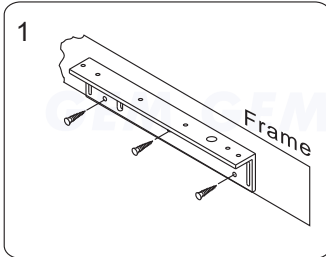

1 Find a mounting location on the door frame for the L bracket. Make sure that the door is still closeable.

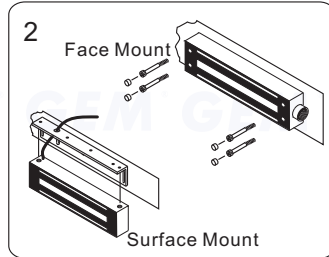

2 Tighten the electromagnetic lock on the L bracket by using the fixing screw. (For the models with Face Mount, the Emlock can be mounted directly on the door frame)

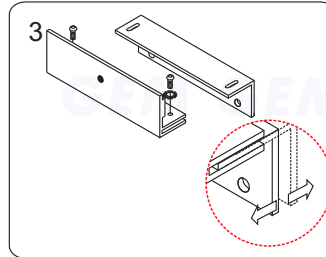

3 Assemble the Z bracket, and make sure that the Z bracket is adjustable.

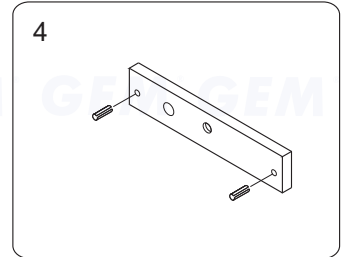

4 Insert the guide pins into the armature plate. The guide pins will prevent the armature plate to pivot around.

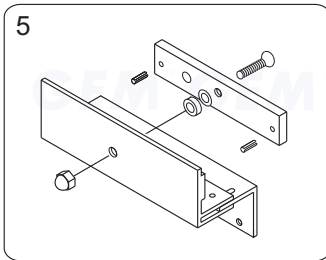

5 Put one rubber washer between armature plate and the Z bracket, and place them over the 8mm armature screw.

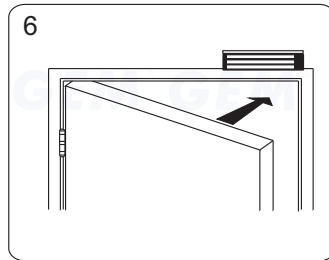

6 Close the door. Measure the correct position by bringing the armature plate close to the contact surface of the electromagnetic lock.

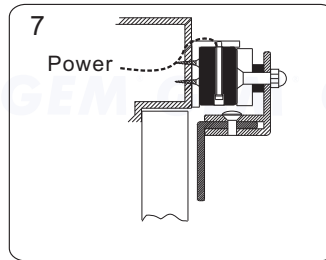

7 Turn on the power of EM-Lock, and let the armature plate bonds to the EM-lock. Adjust the position between the Z bracket and the door frame.

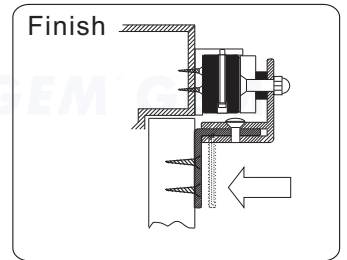

Finish Once the position is correct, use the screws to permanently mount the Z bracket on the door frame. This should be the last step.

Connecting Diagram

Wire Leads	Single Voltage Input	Magnet bond sensor output
2C Wire Leads (Power input is polarity free)	<p>12 VDC: Black, Red</p> <p>24 VDC: Black, White</p>	
4C Wire Leads: Dual voltage (Power input is polarity free)	<p>Voltage Selection: 12 VDC</p> <p>Voltage Selection: 24 VDC</p>	
5C Wire Leads Monitoring Output (Power input is polarity free)		<p>Magnet bond sensor output, remotely monitors the door lock/unlock status. (Rating:0.25A@12VDC)</p> <p>N.C. output while door is unlocked ; N.O. Output while door is locked by the electromagnetic lock.</p> <p>White:N.C. Black:COM. Red:N.O.</p>
6C Wire Leads Dual voltage and Monitoring Output (Power input is polarity free)	<p>Voltage Selection: 12 VDC</p> <p>Voltage Selection: 24 VDC</p>	<p>Magnet bond sensor output, remotely monitors the door lock/unlock status. (Rating:0.25A@12VDC)</p> <p>Reed output is "N.C." while door is unlocked ; Reed output is "N.O." while door is locked by the electromagnetic lock.</p> <p>Blue:COM. Yellow:N.O.</p>